



Tampa Airport Local Area

DOWNTOWN CHANNEL DISTRICT HARBOUR ISLAND

STREETCAR SYSTEM

1 Route & Stops
MON-WED 11am-10pm
THU 11am-11pm
FRI 11am-2am
SAT 9am-2am
SUN Noon-8pm
 Service every 15-20 minutes
 Service every 30 minutes
 9am-11am and 1am-2am
 NOTE: Boarding a streetcar by the final departure time listed ensures access to each station along that route.
 Exact Fare or HARTride Card required

Uptown Downtown Connector
Route 96 Trolley FREE

21 Route & Stops
TROLLEY HOURS
Mon-Fri : 6am-6pm
 Service every 10-15 minutes

STREETCAR STOPS
 DOWNTOWN & CHANNEL DISTRICT

- 1 SOUTHERN TRANSP PLAZA STATION
- 2 HOUSEHOLD FINANCE CORPORATION STATION
- 3 THE TAMPA TRIBUNE STATION
- 4 CUMBERLAND AVENUE STATION
- 5 YORK STREET STATION
- 6 PORT AUTHORITY STATION

MAP LEGEND

- 1 TECO Line Streetcar Route & Stops
- 21 Uptown/Downtown Connector Route & Stops
- P Public Parking Lots / Garages
- ➔ One Way Streets
- i Visitor Information
- H Hospitals

Map courtesy of
 Discover In-Town Tampa
 1-888-FLA-MAPS
HARTline
 Going places.
 Official In-Town Tampa Guide & Map

Downtown Tampa

Tampa Convention Center

First Floor Meeting Space

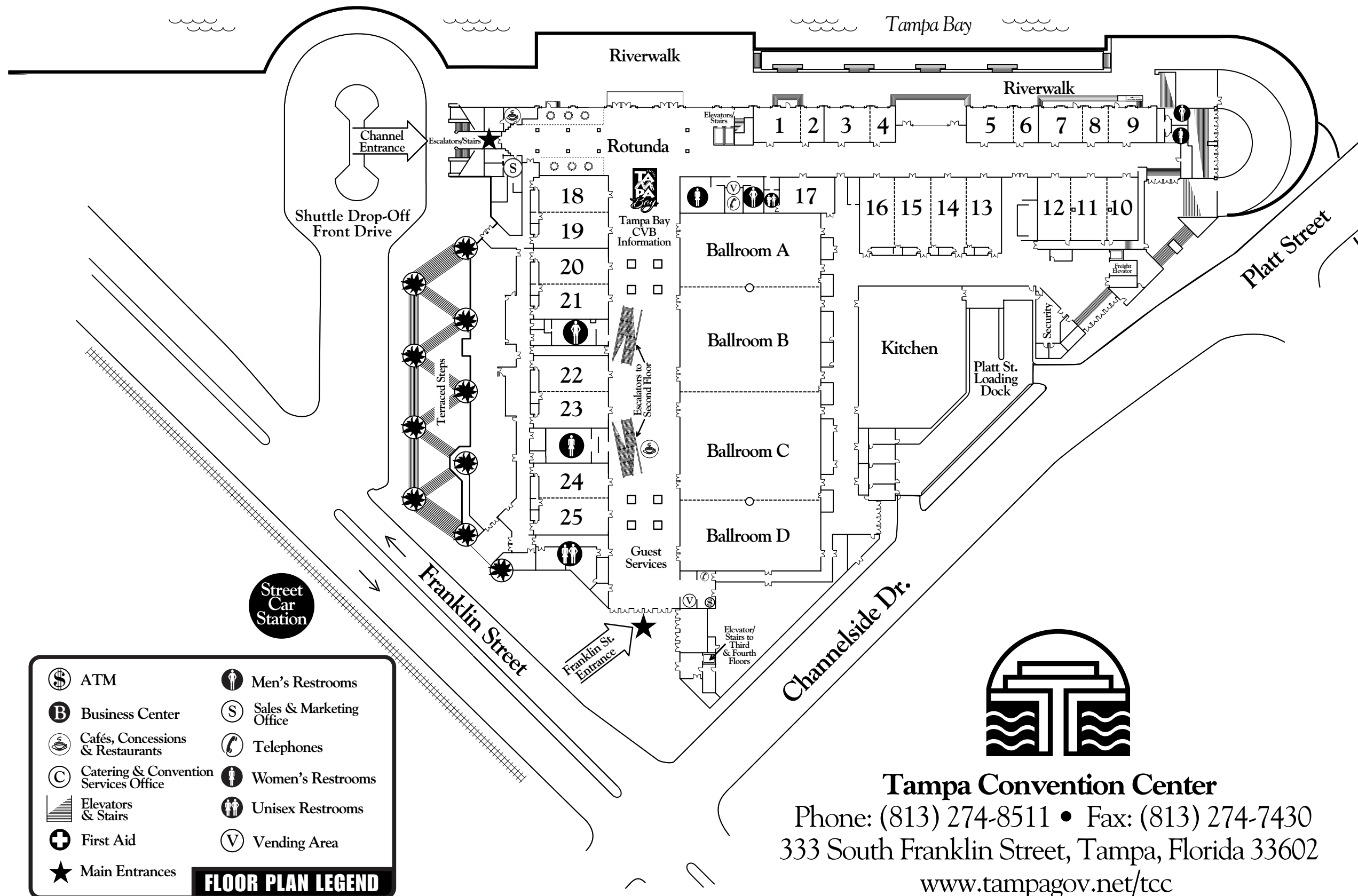

— Tampa Convention Center —

2nd and 3rd Floors

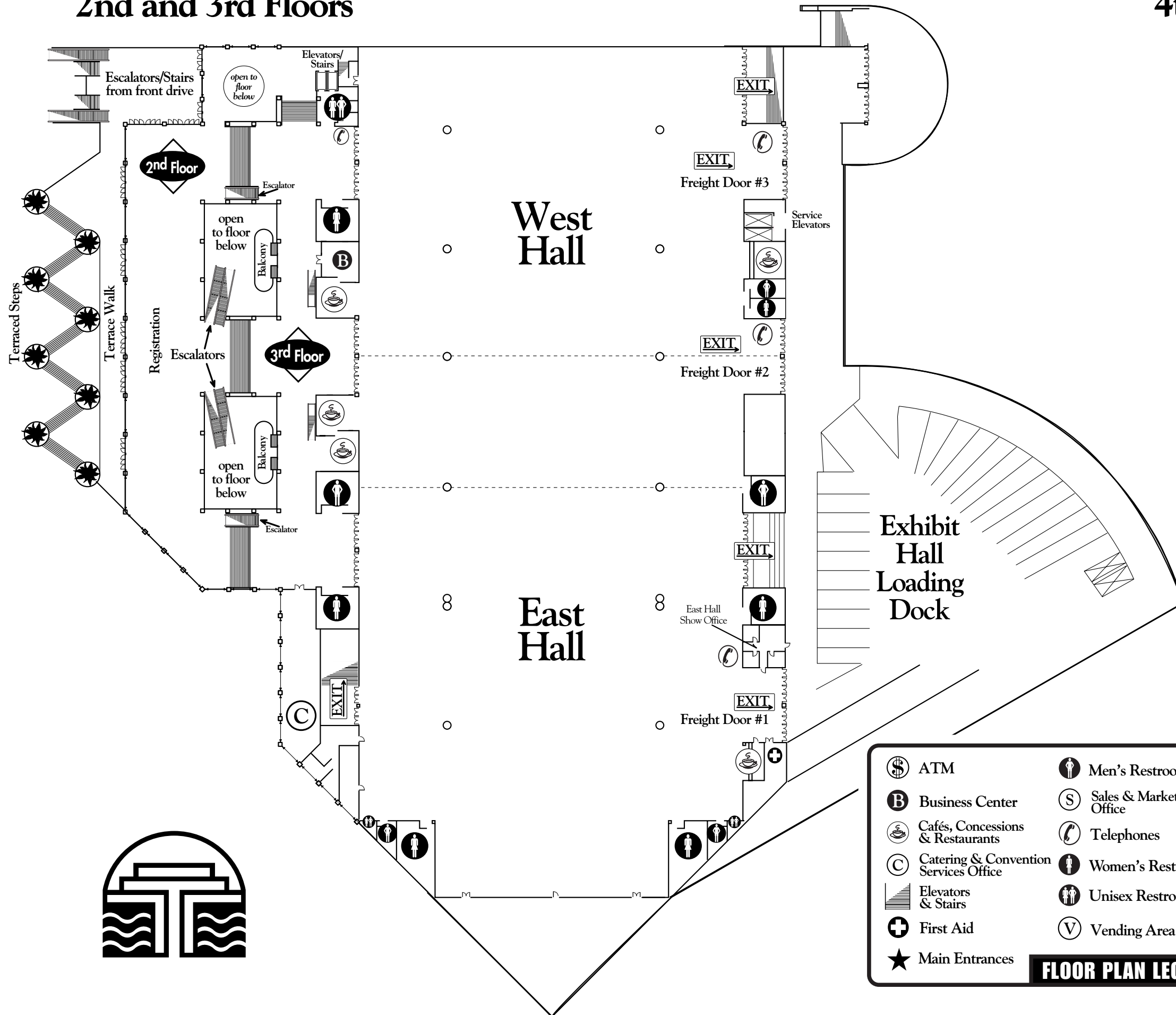

4th Floor

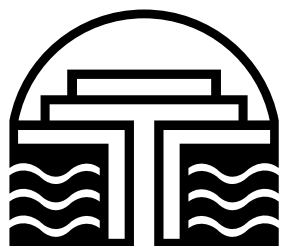
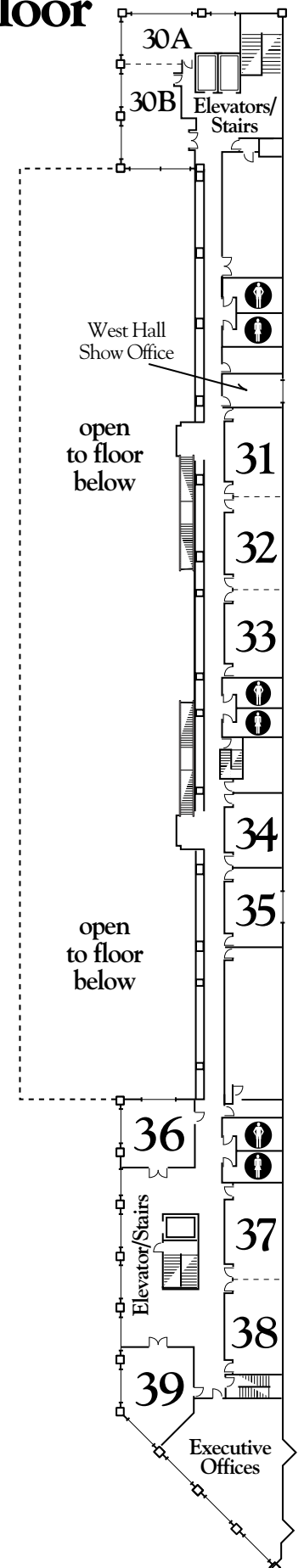

- | | | | |
|---------------------------------------------------------------------------------------|---------------------------------------|---------------------------------------------------------------------------------------|--------------------------|
|  | ATM |  | Men's Restrooms |
|  | Business Center |  | Sales & Marketing Office |
|  | Cafés, Concessions & Restaurants |  | Telephones |
|  | Catering & Convention Services Office |  | Women's Restrooms |
|  | Elevators & Stairs |  | Unisex Restrooms |
|  | First Aid |  | Vending Area |
|  | Main Entrances | | |
- ## FLOOR PLAN LEGEND