

Getting to the University of Oklahoma

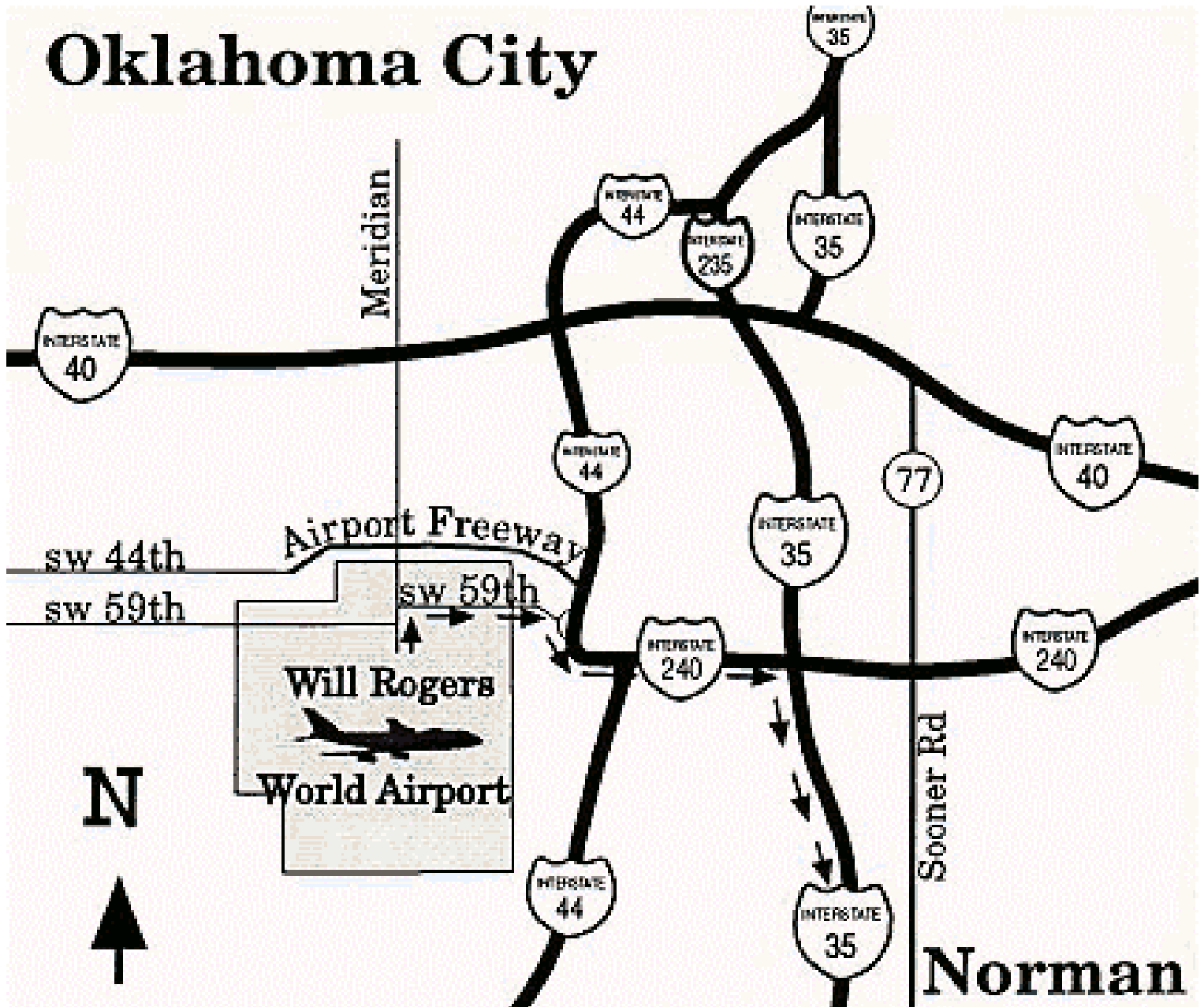

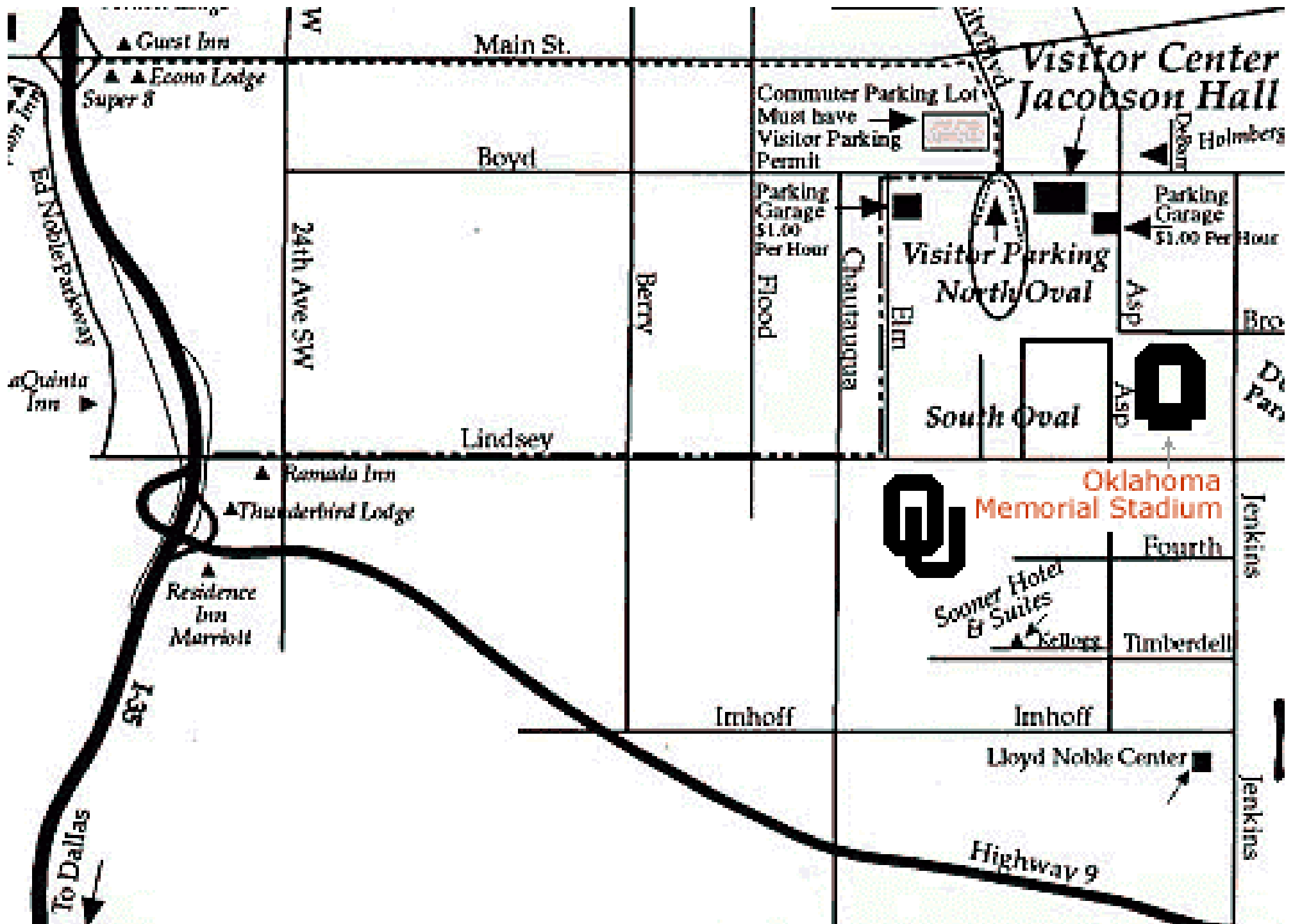

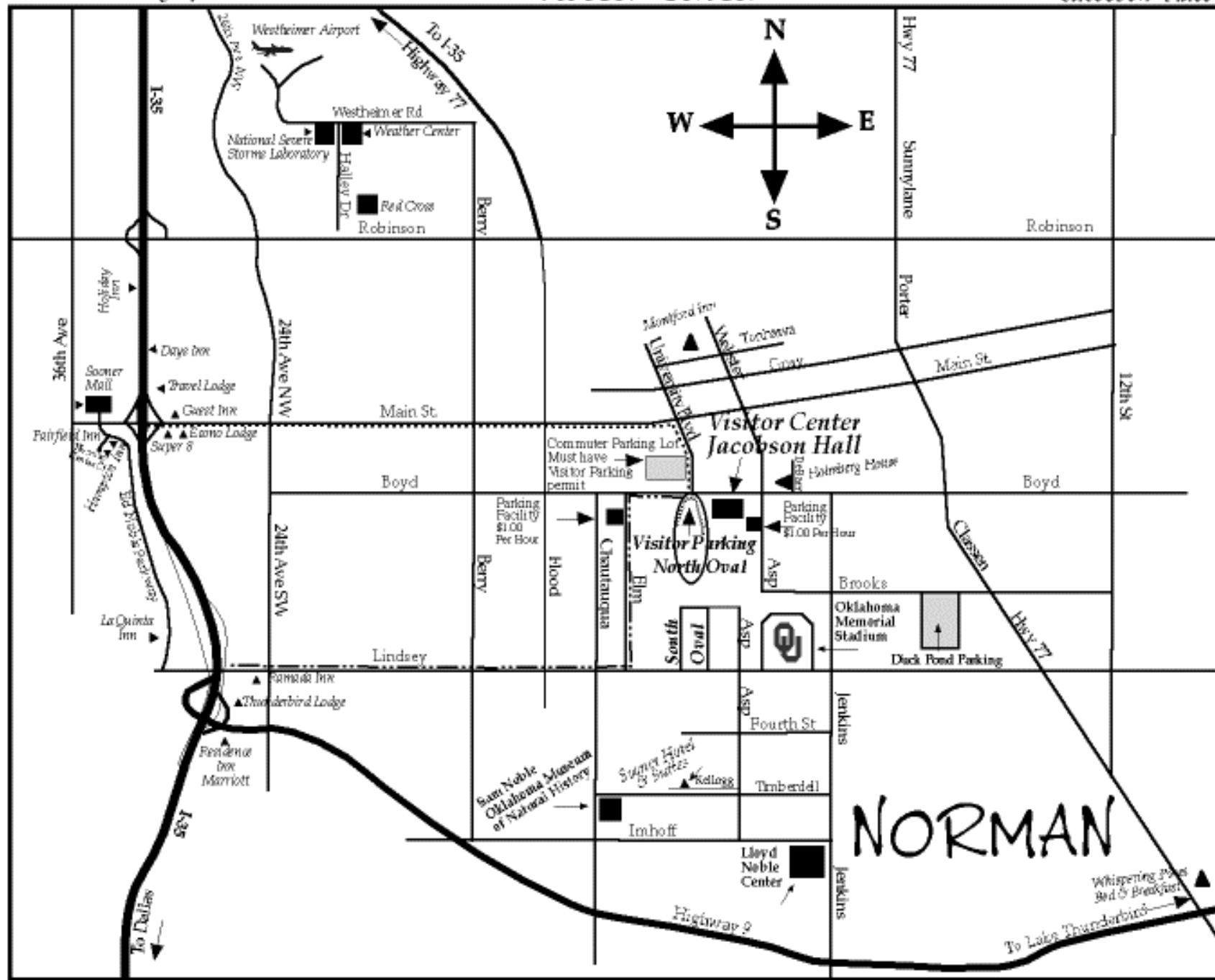



Campus Buildings, by Name

- 39) Adams Center
- 77) Adams Hall, Business
- 76) Armory (Army-Navy ROTC)
- 72) Barry Switzer Center
- 20) Bizzell Memorial Library
 - 1) Boyd House, President's Home
- 79) Buchanan Hall, Admissions
- 71) Bud Wilkinson Residence Hall
- 17) Burton Hall, Communication
 - 6) Carnegie Building, University College
- 90) Carpenter Hall
- 89) Carson Engineering Center
- 37) Cate Center
- 13) Catlett Music Center
 - 9) Chemistry Building
- 28) Collings Hall, Education
- 34) Copeland Hall, Journalism
- 42) Couch Cafeteria
- 41) Couch Center
- 87) Craddock Hall, Air Force ROTC
- 62) Cross Center
- 36) Dale Hall
- 35) Dale Hall Tower
- 19) E.T. Dunlap Plaza and Clock Tower
- 31) Electron Microscopy Laboratory
- 21) Ellison Hall
- 14) Elm Avenue Parking Facility
- 83) Engineering Laboratory
 - 7) Evans Hall, Administration
- 88) Felgar Hall, Engineering
- 75) Field House
- 12) Fine Arts Center, Drama & Dance
- 11) Fred Jones Jr. Memorial Art Center & Museum
- 30) George Lynn Cross Hall, Botany-Microbiology
- 26) Gittinger Hall, English
- 18) Goddard Health Center
- 70) Gomer Jones Residence Hall
- 33) Gould Hall, Architecture
- 32) Greenhouse
- 65) Henderson-Tolson Cultural Center
- 66) Henderson-Tolson Cultural Center, old site
- 23) Hester Hall
- 10) Holmberg Hall, Music
- 38) Honors College
- 63) Huston Huffman Physical Fitness Center
 - 4) Jacobson Hall, Visitor Center
- 69) Jefferson Cafeteria
- 68) Jefferson House Residence Hall
- 22) Jim Thorpe Center

- 27) Kaufman Hall, Languages
- 59) Kraettli Apartments
- 52) L. Dale Mitchell Baseball Park
- 50) Law Center
- 56) Lloyd Noble Center
 - 5) Monnet Hall
- 61) Murray Case Sells Swim Complex
- 25) Nielsen Hall, Physics
- 82) Nuclear Engineering Laboratory, Personnel
- 64) Observatory and Landscape Department
- 47) OCCE Administration Building
- 43) OCCE Commons Restaurant
- 44) OCCE McCarter Hall of Advanced Studies
- 46) OCCE Thurman White Hall (Forum Building)
- 73) Oklahoma Memorial Stadium
- 80) Oklahoma Memorial Union
- 81) Oklahoma Memorial Union Parking Facility
 - 2) Old Faculty Club
 - 8) Old Science Hall, International Relations
- 51) OU Foundation
- 57) Our Children's World Learning Center
- 67) Parkview Apartments
- 85) Physical Plant Complex
- 15) Physical Sciences Center
- 84) Power Plant Offices
- 74) Rhyne Hall, Social Work
- 29) Richards Hall, Zoology
- 24) Robertson Hall, Financial Aid
- 49) Sam Noble Oklahoma Museum of Natural History
- 58) Sam Viersen Gymnastics Center
- 86) Sarkeys Energy Center
- 78) Savoie Lottinville Hall, Press & Printing
- 54) Soccer Facility
- 60) Softball Complex
- 48) Sooner Hotel
- 45) Sooner Suites
- 16) Sutton Hall
- 55) Tennis Complex
- 40) Walker Center
 - 3) Whitehand Hall
- 53) Yorkshire Apartments

The University of Oklahoma



"The front door of the University"

Leslie Baumert, Director (405) 325-1188
 550 Parrington Oval, L-1 1-800-234-6868
 Norman, OK 73019-3032 FAX: (405) 325-7478
 E-Mail: visitor-center@ou.edu

OU's home page - <http://www.ou.edu>
 Monday - Friday 8 a.m. - 5 p.m.
 Saturday 9 a.m. - noon

Visitor Parking - Please stop by the Visitor Center when you arrive on campus. Visitor Parking permits will be issued for all areas designated as Visitor Parking. These areas are highlighted on the map. Guests may also park in other lots by requesting entrance through the speaker phone located at each gated lot. A Visitor Parking permit is required in all lots. Two public parking facilities are also available north of the Oklahoma Memorial Union and on Elm Avenue south of Catlett Music Center. Rates are \$1 per hour or up to a maximum of \$7 per day.

Tours - Prospective Student Tours are offered Monday through Friday at 9 a.m. and 2 p.m. and on Saturday at 9:30 a.m. (except on holidays). Historical campus tours and group tours may also be scheduled by calling the Visitor Center at (405) 325-1188 or 800-234-6868. All tours depart from the Visitor Center located in Jacobson Hall. For accommodations on the basis of disability, please call (405) 325-1188.

Brochures, Maps and Information - The Visitor Center is a State of Oklahoma Local Tourism Information Center. Guests may pick up state and local tourism brochures in addition to OU information.

Visitor Parking - Please stop by the Visitor Center when you arrive on campus. Visitor Parking permits will be issued for all areas designated as Visitor Parking. These areas are highlighted on the map. Guests may also park in other lots by requesting entrance through the speaker phone located at each gated lot. A Visitor Parking permit is required in all lots. Two public parking facilities are also available north of the Oklahoma Memorial Union and on Elm Avenue south of Catlett Music Center. Rates are \$1 per hour or up to a maximum of \$7 per day.



- 1 Boyd House, President's Home
- 2 Old Faculty Club
- 3 Whitehand Hall
- 4 Jacobson Hall, Visitor Center
- 5 Monnet Hall
- 6 Carnegie Building, University College
- 7 Evans Hall, Administration
- 8 Old Science Hall, International Relations
- 9 Chemistry Building
- 10 Holmberg Hall, Music
- 11 Fred Jones Jr. Memorial Art Center & Museum
- 12 Fine Arts Center, Drama & Dance
- 13 Catlett Music Center
- 14 Elm Avenue Parking Facility
- 15 Physical Sciences Center
- 16 Sutton Hall
- 17 Burton Hall, Communication
- 18 Goddard Health Center
- 19 E.T. Dunlap Plaza and Clock Tower
- 20 Bizzell Memorial Library
- 21 Ellison Hall
- 22 Jim Thorpe Center
- 23 Hester Hall
- 24 Robertson Hall, Financial Aid
- 25 Nielsen Hall, Physics
- 26 Gittinger Hall, English
- 27 Kaufman Hall, Languages
- 28 Collings Hall, Education
- 29 Richards Hall, Zoology
- 30 George Lynn Cross Hall, Botany-Microbiology
- 31 Electron Microscopy Laboratory
- 32 Greenhouse
- 33 Gould Hall, Architecture
- 34 Copeland Hall, Journalism
- 35 Dale Hall Tower
- 36 Dale Hall
- 37 Cate Center
- 38 Honors College
- 39 Adams Center
- 40 Walker Center
- 41 Couch Center
- 42 Couch Cafeteria
- 43 OCCE Commons Restaurant
- 44 OCCE McCarter Hall of Advanced Studies
- 45 Sooner Suites
- 46 OCCE Thurman White Hall (Forum Building)
- 47 OCCE Administration Building
- 48 Sooner Hotel
- 49 Sam Noble Oklahoma Museum of Natural History
- 50 Law Center
- 51 OU Foundation
- 52 L. Dale Mitchell Baseball Park
- 53 Yorkshire Apartments
- 54 Soccer Facility
- 55 Tennis Complex
- 56 Lloyd Noble Center
- 57 Our Children's World Learning Center
- 58 Sam Viersen Gymnastics Center
- 59 Kraetli Apartments
- 60 Softball Complex
- 61 Murray Case Sells Swim Complex
- 62 Cross Center
- 63 Huston Huffman Physical Fitness Center
- 64 Observatory and Landscape Department
- 65 Henderson-Tolson Cultural Center, future site
- 66 Henderson-Tolson Cultural Center
- 67 Parkview Apartments
- 68 Jefferson House Residence Hall
- 69 Jefferson Cafeteria
- 70 Gomer Jones Residence Hall
- 71 Bud Wilkinson Residence Hall
- 72 Barry Switzer Center
- 73 Oklahoma Memorial Stadium
- 74 Rhynne Hall, Social Work
- 75 Field House
- 76 Armory (Army-Navy ROTC)
- 77 Adams Hall, Business
- 78 Savoie Lottinville Hall, Press & Printing
- 79 Buchanan Hall, Admissions
- 80 Oklahoma Memorial Union
- 81 Oklahoma Memorial Union Parking Facility
- 82 Nuclear Engineering Laboratory, Personnel
- 83 Engineering Laboratory
- 84 Power Plant Offices
- 85 Physical Plant Complex
- 86 Sarkeys Energy Center
- 87 Craddock Hall, Air Force ROTC
- 88 Felgar Hall, Engineering
- 89 Carson Engineering Center
- 90 Carpenter Hall

PARKING Visitor (No student or employee parking) Customer (30 minute limit)

Getting to the Schusterman Center, Tulsa

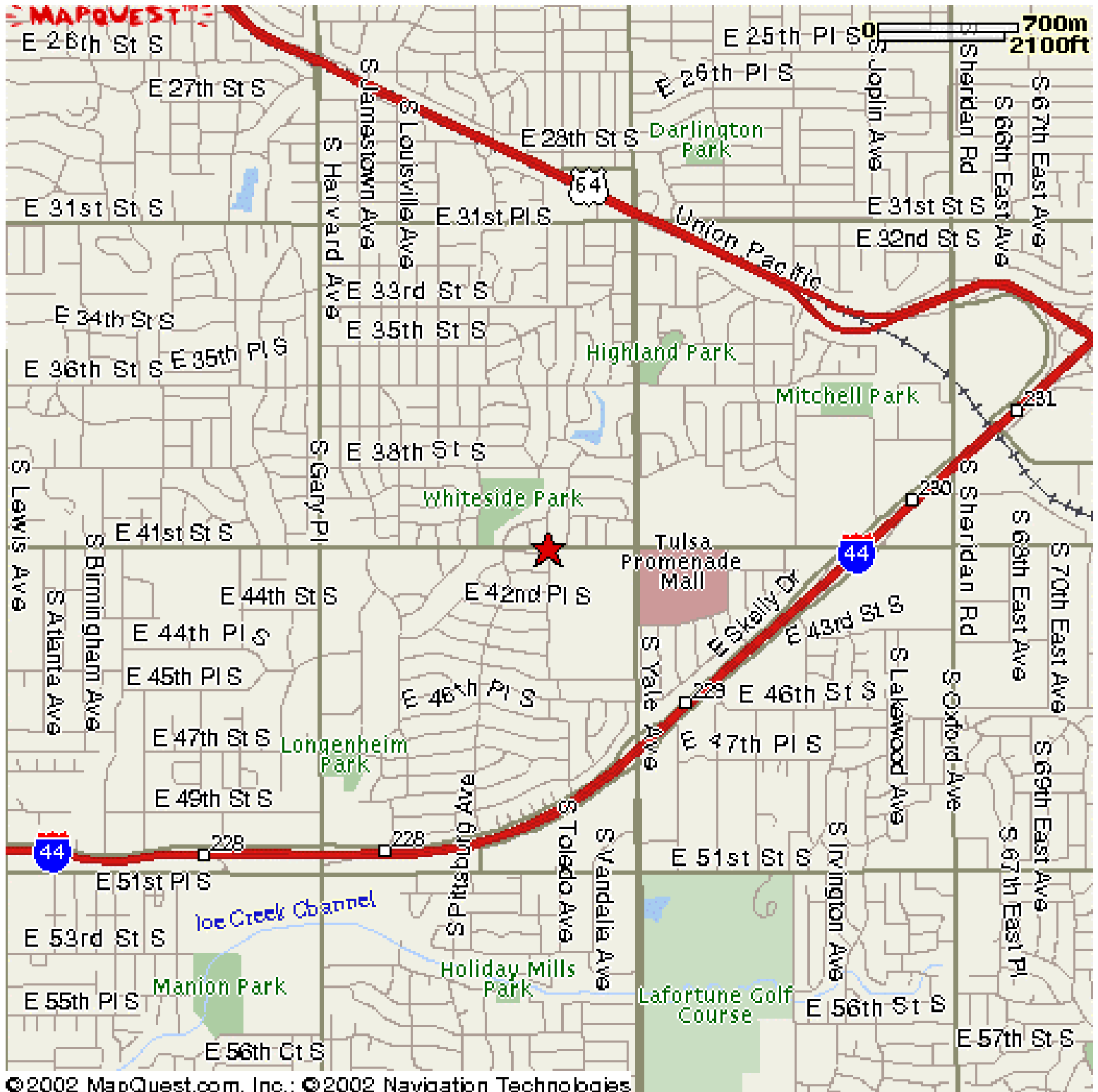

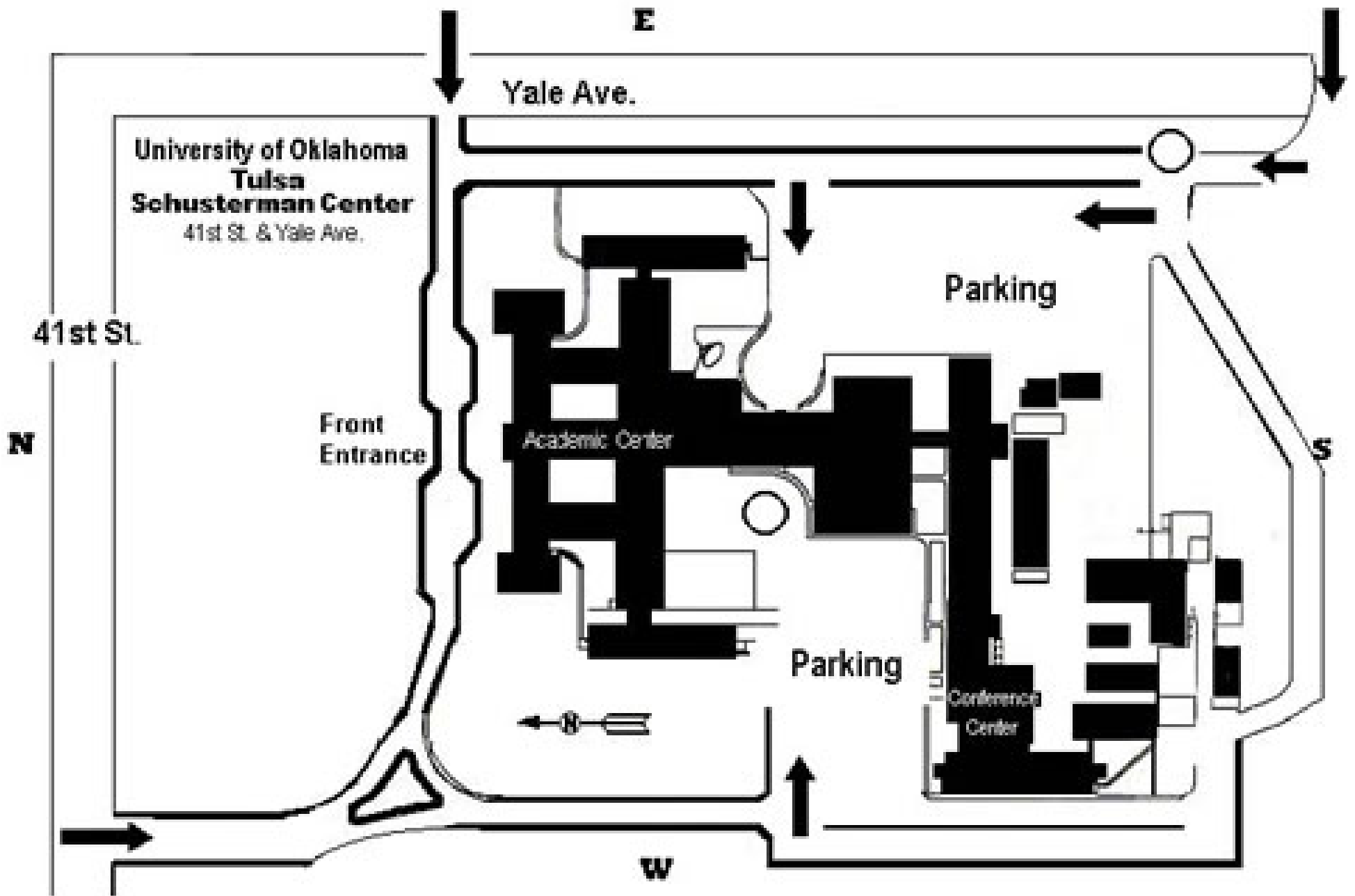



University of Oklahoma

Health Sciences Center

1100 N. Lindsay, Oklahoma City, OK 73104 (405) 271-4000

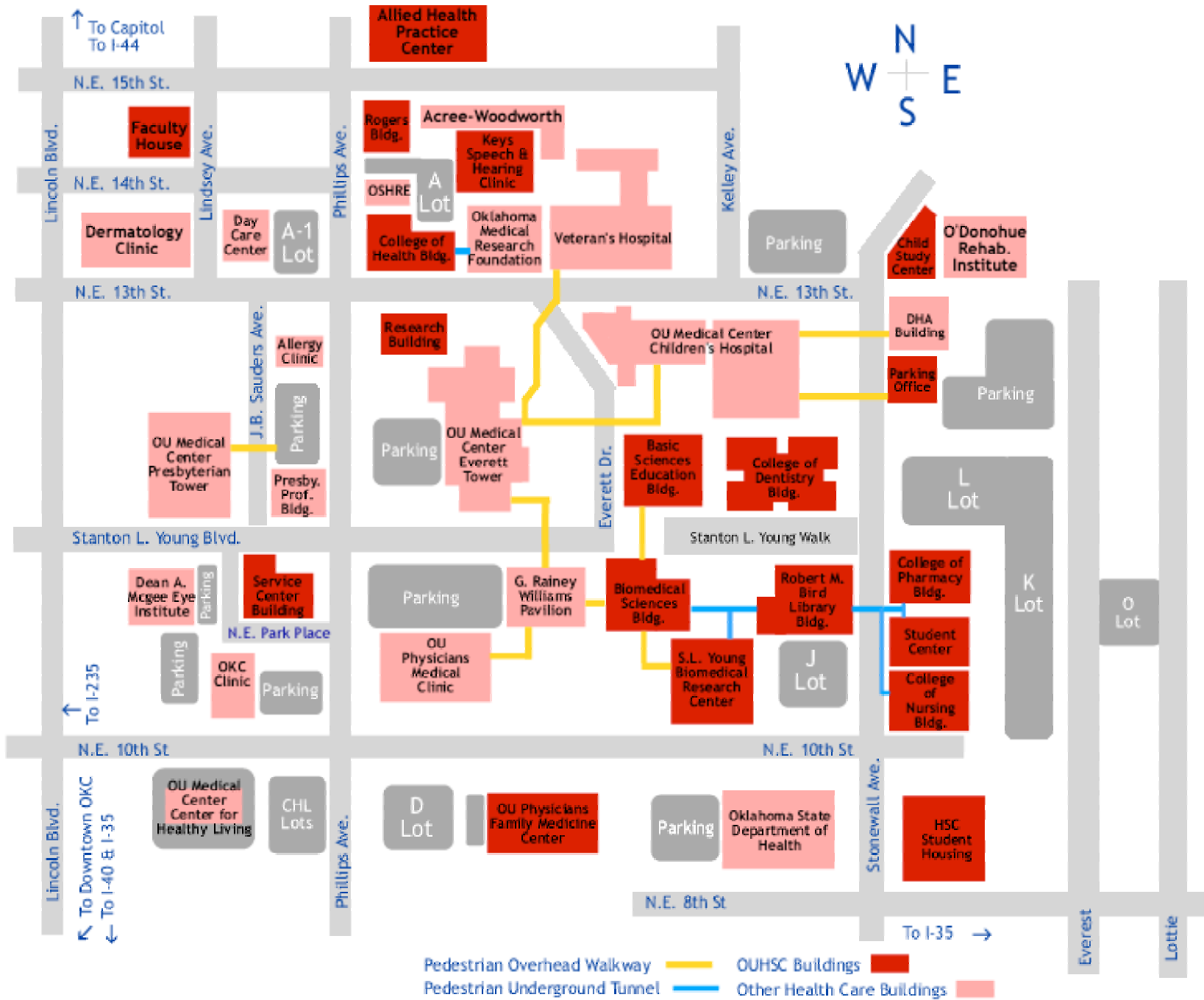



THE UNIVERSITY OF OKLAHOMA

ACADEMIC YEAR 2000-2001

A B C D E F G H I J K L

1 2 3 4 5 6 7 8 9 10 11 12 13 14 15 16 17 18 19 20 21 22

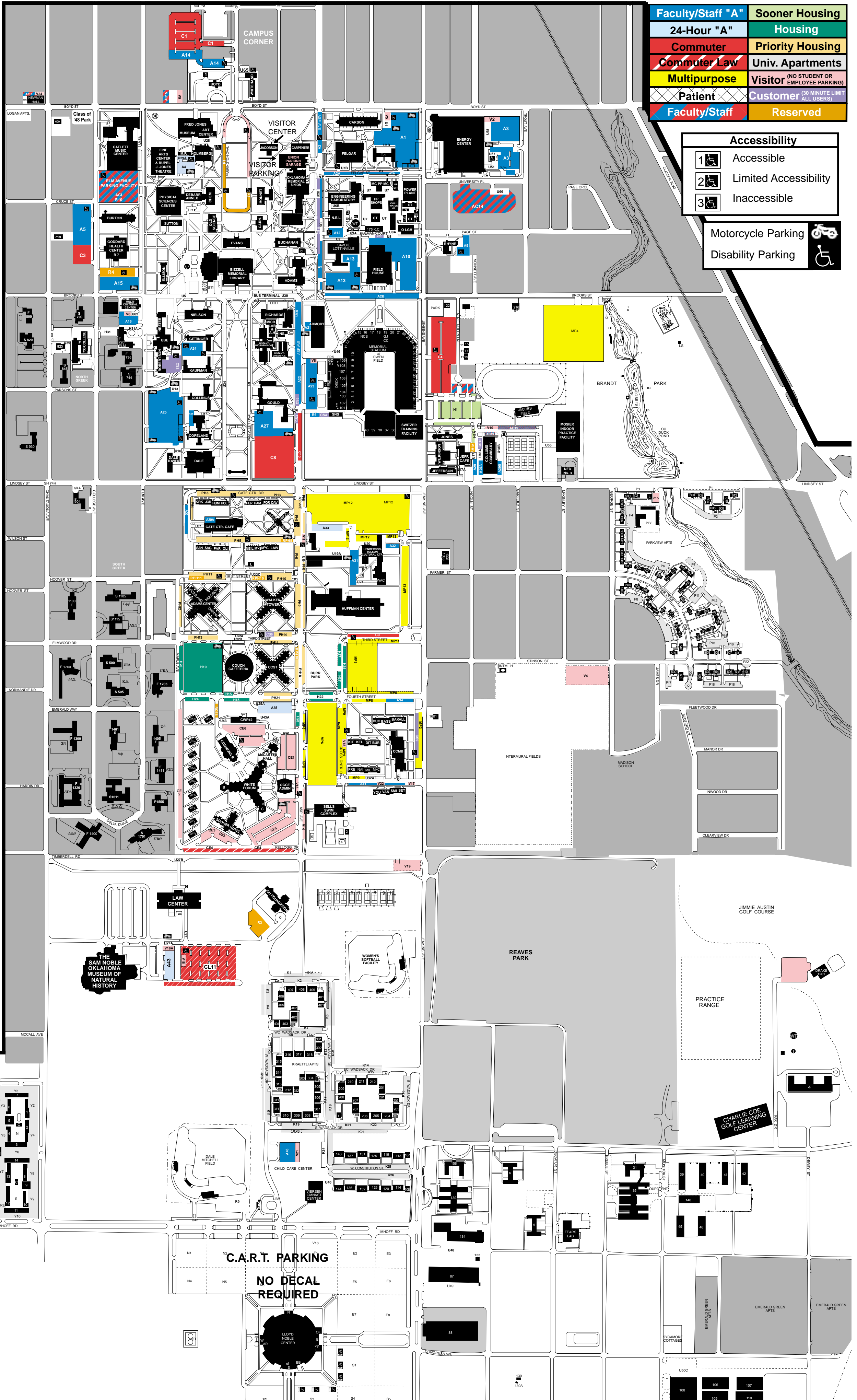

Faculty/Staff "A"	Sooner Housing
24-Hour "A"	Housing
Commuter	Priority Housing
Commuter Law	Univ. Apartments
Multipurpose	Visitor (NO STUDENT OR EMPLOYEE PARKING)
Patient	Customer (30 MINUTE LIMIT ALL USERS)
Faculty/Staff	Reserved

Accessibility	
1	Accessible
2	Limited Accessibility
3	Inaccessible

Motorcycle Parking

Disability Parking

- C10—Adams Center
- E5—Adams Hall
- E13—Administration Building (OCCE)
- F3—Air Force ROTC (T-1)
- E5—Armory (Army & Navy ROTC)
- D5—Bizzell Memorial Library
- D6—George Lynn Cross
- D2—Boyd House
- E4—Buchanan Hall
- B4—Burton Hall
- D4—Carnegie Building
- E3—Carpenter Hall
- F3—Carson Engineering Center
- D8—Cate Center
- B3—Catlett Music Center
- D3—Chemistry Building
- H7—Collums Commissary
- D12—Commons Restaurant (OCCE)
- C7—Copeland Hall, Journalism
- C12—Cottages (OCCE)
- E5—Couch Cafeteria
- D11—Couch Center
- F12—Cross Center
- D7—Dale Hall
- C7—Dale Hall Tower
- C5—Elison Hall
- B3—Elm Ave Parking Facility
- G3—Energy Center
- E4—Engineering Laboratory
- D4—Evans Hall, Administration Bldg.
- F19—Fears Structural Engineering Laboratory
- F3—Felgar Hall
- F5—Field House
- C3—Fine Arts Center, Drama
- D12—Forum Building (OCCE)
- C2—Fred Jones Jr. Memorial Art Center
- C6—Gittinger Hall, English
- B4—Goddard Health Center
- K14—Golf Course
- E6—Gold Hall
- F9—Henderson-Tolson Cultural Center
- C5—Hester Hall
- C3—Holmberg Hall, Music
- G3—Housing Offices
- F10—Huston Huffman Physical Fitness Center
- H6—Jacobs Field, Track
- D3—Jacobson Hall (Visitor Center)
- G8—Jefferson House
- B5—Jim Thorpe Multi-Cultural Center
- G7—Jones House
- C6—Kaufman Hall
- E16—Kraettli Apartments
- C14—Law Center
- D21—Lloyd Noble Center
- F4—Lottinville Hall, Press & Printing
- F12—McCarter Hall of Advanced Studies (OCCE)
- D18—L. Dale Mitchell Baseball Park
- D3—Monnet Hall
- I7—Mosier Indoor Athletic Facility
- G20—Motor Pool
- A2—Newman Hall
- D5—Nelson Hall, Physics
- E4—Nuclear Engineering Laboratory
- E9—Observatory
- F21—Oil Well Blowout Prevention School
- F6—Oklahoma Memorial Stadium
- E3—Oklahoma Memorial Union
- J18—Oklahoma University Police Division (OUPD)
- C6—Parking Services (Robertson Hall)
- J8—Parkview Apartments
- F4—Personnel Services (NEL Building)
- F4—Physical Plant Complex
- C3—Physical Sciences Center
- J19—Police Division
- G4—Rhyne Hall, Social Work
- D5—Richards Hall, Zoology
- C6—Robertson Hall
- C3—Rupel J. Jones Theatre, Drama
- B15—Sam Noble Museum of Natural History
- D4—Science Hall
- E13—Sells Swim Complex
- D13—Sooner Hotel (OCCE)
- K22—Storeroom
- C4—Sutton Hall
- H7—Tennis Courts
- D12—Thurman White Hall (Forum Bldg. OCCE)
- C6—University Book Exchange (Main Store)
- D14—University of Oklahoma Foundation
- E19—Verson Gymnastics Center
- D10—Walker Tower
- G7—Wilkinson House
- D2—Whitehand Hall
- A17—Yokshire Apartments



THE UNIVERSITY OF OKLAHOMA

Main Campus Map



Parking

NUMERICAL LISTINGS

- 1 Old Faculty Club
- 2 Boyd House
- 3 Whitehand Hall
- 5 Fred Jones Jr. Memorial Art Center
- 6 Carson Engineering Center
- 8 Sarkeys Energy Center
- 9 Rupe J. Jones Theater
- 10 Holmberg Hall
- 11 Jacobson Faculty Hall
- 12 Carpenter Hall
- 13 Felgar Hall
- 14 Craddock Hall
- 15 Stanley Catlett Music Center
- 18 Physical Sciences Center
- 19 Chemistry Building
- 19A Chemistry Bldg. Annex
- 20 Monnet Hall
- 21 Oklahoma Memorial Union
- 21A OMU Parking Center
- 22 Engineering Laboratory
- 23 Physical Plant Complex
- 27 Burton Hall
- 28 Sutton Hall
- 29 Science Hall
- 30 Carnegie Building
- 31 Nuclear Engineering Laboratory
- 38 Goddard Health Center
- 39 Jim Thorpe Multicultural Center
- 40 Evans Hall
- 41 Buchanan Hall
- 43 Telecom Maintenance
- 46 Ellison Hall
- 49 Bizzell Memorial Library
- 49A Bizzell Library 1958 Addition
- 49B Neustadt Wing
- 50 Adams Hall
- 51 Savoie Lottinville Hall
- 52 Field House
- 53 Rhyne Hall
- 56 Hester Hall
- 56A Robertson Hall
- 57 Nielsen Hall
- 58 Richards Hall
- 58A Richards Hall Addition
- 59 Armory
- 61 Gittinger Hall
- 62 George Lynn Cross Hall
- 63B Noble Microscopy Laboratory
- 66 Oklahoma Memorial Stadium
- 67 Kaufman Hall
- 68 Ellsworth Collings Hall
- 69 Gould Hall
- 70 Copeland Hall
- 71 Dale Hall Tower
- 72 Dale Hall Classroom Building
- 75 Gomer Jones Dormitory
- 77 Jefferson House Dormitory
- 78 Collum Commissary
- 79 Jacobs Field
- 80 Bud Wilkinson Dormitory
- 81 Mosier Indoor Athletic Facility
- 82 Cate Center
- 87 Honors House (Cate Center Dorm #5)
- 88 Henderson-Tolson Cultural Center
- 93 Observatory
- 94 Wilson Center Main Bldg.
- 99 Adams Center
- 100 Walker Tower
- 103 Huston Huffman Physical Fitness Center
- 107 Couch Center Cafeteria
- 108 Couch Center South
- 113 OCCE Cottages
- 121 OCCE Commons Restaurant
- 122 OCCE McCarter Hall of Advanced Studies
- 124 Cross Center
- 128 OCCE Forum Building
- 129 OCCE Administration Building
- 136 OCCE Sooner House
- 137 Murray Case Sells Swim Complex
- 200 Law Center
- 201 Kraettli Apartments
- 203 Women's Softball Facility
- 204 OU Foundation
- 205 Sam Noble Oklahoma Museum of Natural History
- 207 Our Children's World Learning Center
- 209 Building 4 (Continuing Education)
- 210 L. Dale Mitchell Baseball Park
- 211 Sam Viersen Gymnastics Center
- 213 Bldg. 6, South Campus
- 215 Department of Public Safety
- 226 Fears Structural Engineering Lab
- 228 Oklahoma Biological Survey
- 236 Ceramic Kiln Facility
- 247 Lloyd Noble Center
- 249 Parkview Apartments
- 404 Yorkshire Apartments
- 707 Oil Well Blowout School

CLASSROOM BUILDINGS

- AH* Adams Hall (50)
- ARM Armory (59)
- BL Bizzell Library (49)
- BL1* Bizzell Library (49A)
- BURT* Burton Hall (27)
- CARN* Carnegie Building (30)
- CCDS Honors House (87)
- CEC* Carson Engineering Center (6)
- CH* Carpenter Hall (12)
- CHB Chemistry Building (19)
- CHBA Chemistry Building Annex (19A)
- CMC* Catlett Music Center (15)
- COH* Copeland Hall (70)
- COLM* Commissary (78)
- CRAD Craddock Hall (14)
- CRSM* Cross Main (124)
- CSKF Ceramic Kiln Facility (236)
- DAH* Dale Hall (72)
- DAHT* Dale Hall Tower (71)
- EL Ellsworth Collings Hall (68)
- EL Engineering Lab (22)
- FAC* Fine Arts Center (9)
- FH* Felgar Hall (13)
- FIH Field House (52)
- FJC* Fred Jones Art Center (5)
- FL Fears Lab (226)
- FORM Forum OCCE (128)
- GH* Gould Hall (69)
- GIH* Gittinger Hall (61)
- GLCH* George Lynn Cross Hall (62)
- HEST* Hester Hall (56)
- HH Holmberg Hall (10)
- HHC* Huston Huffman Physical Fitness Center (103)
- JFH* Jacobson Faculty Hall (11)
- KH* Kaufman Hall (67)
- LC* Law Center (200)
- MH Monnet Hall (20)
- MUSE Observatory (93)
- NH* Nielsen Hall (57)
- NML* Noble Microscopy Lab (63B)
- N101 Airport Operations, North Campus (335)
- OBS* Oklahoma Biological Survey (228)
- OFC Old Faculty Club (1)
- OMS Oklahoma Memorial Stadium (66)
- OMNH* Sam Noble Oklahoma Museum of Natural History (205)
- PHSC* Physical Sciences Center (18)
- POOL Murray Case Sells Swim Complex (137)
- RH Richards Hall (58)
- RHA Richards Hall Addition (58A)
- RHYN Rhyne Hall (53)
- SCI Science Hall (29)
- SEC* Sarkeys Energy Center (8)
- SUT Sutton Hall (28)
- S6 Bldg. 6, South Campus (213)
- WHIT* Whitehand Hall (3)

*Buildings accessible to persons with disabilities

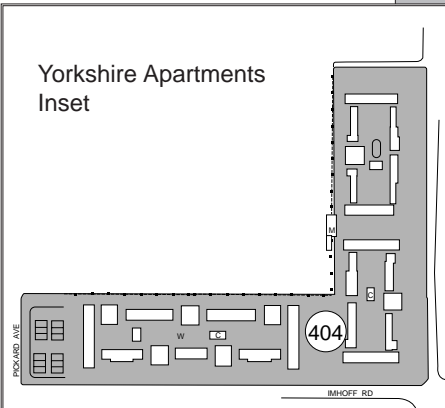

CAMPUS INFORMATION DIRECTORY

QUESTIONS	OFFICE	LOCATION	TELEPHONE
ACT Test	Counseling & Testing Services	Goddard Health Center, Rm. 201	325-2911
Address Changes	Registration Office	Buchanan Hall, Rm. 230	325-3572
Add/Drop	Registration Office	Buchanan Hall, Rm. 230	325-3572
Admissions	Admissions Office	Buchanan Hall, Rm. 127	325-2252
Advance Standing Exams	Admissions Office	Buchanan Hall, Rm. 127	325-2252
Advising	College Office	See List Below	
African American Student Services	Center for Student Life	Student Union, 3rd Floor South	325-3163
American Indian Student Services	Center for Student Life	Student Union, 3rd Floor South	325-3163
Asian American Student Services	Center for Student Life	Student Union, 3rd Floor South	325-3163
Assessment	Assessment Center	Carnegie Bldg., 2nd Floor	325-1684
Audit Forms	Registration Office	Buchanan Hall, Rm. 230	325-3572
Books and Supplies	Bookstore	Asp Avenue Parking Facility	325-3511
Cancellation of Enrollment	Registration Office	Buchanan Hall, Rm. 230	325-3572
Catalogs	Bookstore	Asp Avenue Parking Facility	325-3511
Child Care Center	Our Children's World Learning Center	501 Wadsack St.	325-0528
Class Schedule	Online	http://www.ou.edu/admrec/registration.html	
CLEP Examination	Independent Study	1600 S. Jenkins	325-4414
Commuter Student Information	Commuter Student Assoc.	Conoco Student Leadership Wing	325-1031
Continuing Education	College of Continuing Education	OCCE Admin., Rm. B-4	325-1021
Counseling (Personal)	Counseling & Testing Services	Goddard Health Center, Rm. 201	325-2911
Disabled Student Services	Office of Disability Services	Goddard Health Center, Rm. 166	325-3852
			or TDD 325-4173
Employment	Personnel Services	Nuclear Engr. Lab., Rm. 205	325-1826
Enrollment	Online/Registration Office	enroll.ou.edu/Buchanan Hall , Rm. 230	325-3572
Evening Student Services	Center for Student Life	Student Union, Rm. 206	325-4028
Fees (payment of University Bills)	Bursar	Buchanan Hall, Rm. 105	325-3122
Financial Aid	Financial Aid Office	Buchanan Hall, Rm. 216	325-4521
Grades (Semester)	Records Office	Buchanan Hall, Rm. 330	325-4147
Graduation	College Office	See List Below	
(a) Application	College Office		
(b) Cap and Gown	Bookstore	Buchanan Hall, Rm. 330	325-4147
(c) Diplomas	Records Office	Asp Avenue Parking Facility	325-3511
(d) Invitations	Bookstore	Asp Avenue Parking Facility	325-3511
(e) Rings	Bookstore	Asp Avenue Parking Facility	325-3511
Health Insurance (Student)	Insurance Office	Nuclear Engineering Lab	325-9196
Hispanic/Latin Student Services	Center for Student Life	Student Union, 3rd Floor South	325-3163
Housing Programs	Campus Services	Walker Tower, Rm. 126	325-2511
ID Cards	OneCard Office	Student Union, Rm. 127	325-3113
Independent Study (Correspondence)	Independent Study	OCCE Admin., Rm. B-1	325-1921
International Student Information	International Student Services	Old Science Hall, Rm. 103	325-3337
Internships	Career Services	Student Union, Rm. 323	325-1974
Intersession	Intersession Office	OCCE Admin., Rm. 202	325-2899
Intramural & Recreational Sports	Recreational Services	Huston Huffman Center, Rm. 149	325-3053
Jobs on Campus	Employment and Compensation	NEL, Rm. 205	325-1826
Library Books	Bizzell Library	Bizzell Library	325-3341
Loans, Scholarships, Grants	Financial Aid Services	Buchanan Hall, Rm. 216	325-4521
(a) Disbursement	Bursar's Office	Buchanan Hall, Rm. 105	325-3123
Medical Services	Goddard Health Center	Goddard Health Center	325-4441
Name Changes	Records Office	Buchanan Hall, Rm. 330	325-4147
Prospective Student Information	Prospective Student Services	Jacobson Hall, Rm. L1	325-2151
Parking Permits	Parking & Transit	Robertson Hall, Rm. 311	325-3311
Parking Tickets	Parking & Transit	Robertson Hall, Rm. 311	325-3311
Placement Tests	Assessment & Learning Center	Carnegie Bldg., Rm. 200	325-4336
Reading Clinic	College of Education	Education Bldg., Rm. 127	325-4844
Readmission	Admissions Office	Buchanan Hall, Rm. 127	325-2252
Records (Academic)	Records Office	Buchanan Hall, Rm. 330	325-4147
Residency	Admissions Office	Buchanan Hall, Rm. 127	325-2252
Sports Information	Athletic Department	Oklahoma Memorial Stadium	325-8231
Tickets (Athletic)	Athletic Ticket Office	Stadium, Gate 15	325-6511
Tickets (Fine Arts)	Fine Arts Ticket Service	Fine Arts Center, Rm. 123	325-4101
TOEFL	Counseling & Testing Services	Goddard Health Center, Rm. 201	325-2911
Transcripts of Student Records	Records Office	Buchanan Hall, Rm. 330	325-4147
Transfer Student Information	Prospective Student Services	Jacobson Hall, Rm. L1	325-2151
Verification of Enrollment	Records Office	Buchanan Hall, Rm. 330	325-4147
Veterans Affairs	Veterans Office	Buchanan Hall, Rm. 231	325-4308
Veterans Student Services	Office of Veteran Services	Goddard Health Center, Rm. 166	325-3852
Withdrawal from University (all Classes)	College Office	See List Below	

COLLEGE OFFICE LOCATION

OFFICE	LOCATION	TELEPHONE
Architecture	Gould Hall, Rm. 162	(405) 325-2444
Arts and Sciences	Ellison Hall, Rm. 124	(405) 325-4411
Business Administration	Adams Hall, Rm. 105	(405) 325-6021
Continuing Education	OCCE Admin., Rm. 111	(405) 325-4414
Education	Ellsworth Collings Hall, Rm. 114	(405) 325-1081
Engineering	Felgar Hall, Rm. 112	(405) 325-4096
Fine Arts	Fred Jones Jr. Memorial Art Center, Rm. 122	(405) 325-7370
Geosciences	Energy Center Tower, Rm. 710	(405) 325-3101
Graduate	Buchanan Hall, Rm. 313	(405) 325-3811
Journalism	Copeland Hall, Rm. 101	(405) 325-2721
Liberal Studies	OCCE Admin., Rm. 226	(405) 325-1061
Law	Law Center, Rm. 200	(405) 325-4699
University College	Carnegie Bldg., Rm. 100	(405) 325-3521
Special Students		
(a) With Degrees	Buchanan Hall, Rm. 313	(405) 325-3811
(b) Without Degrees	Carnegie Bldg., Rm. 100	(405) 325-3521